

# 160 Series Flush Mount

## Corner Guard

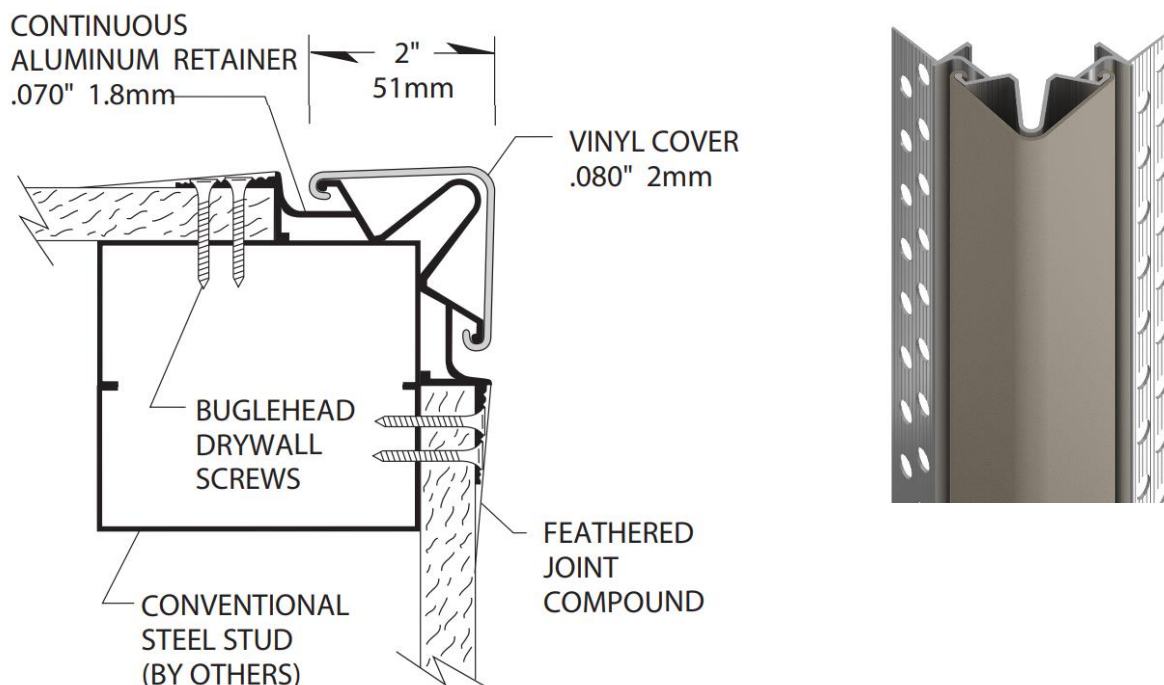

- 51mm wing with 90° corner protection
- Mounted on a sturdy 1.8mm pre-punched continuous aluminium retainer
- 2mm thick scratch and stain resistant rigid vinyl cover
- Manufactured in 1.22m, 2.44m, 2.74m and 3.66m standard heights, custom heights and angles available
- All mounting fasteners are included with each order
- Available in 100 standard colours and Woodland patterns
- Meets the most rigorous standards and criteria of chemical emissions as prescribed by the GREENGUARD Environmental Institute
- Has been tested and meets GREENGUARD Environmental Institute's and the state of California's requirements for low emitting products as tested by Air Quality Sciences
- Has been tested and meets the GREENGUARD Children & School chemical emissions levels

# 160 Series Flush Mount Corner Guard

## PART 1 - GENERAL

### 1.01 SUMMARY

A. Corner guard system for wall protection

### 1.02 SECTION INCLUDES

A. 160F Flush Mount Corner Guard Systems

### 1.03 REFERENCES

A. American Society for Testing and Materials (ASTM)

B. National Building Code of Canada (NBC)

C. National Fire Protection Association (NFPA)

D. Society of Automotive Engineers (SAE)

E. Underwriters Laboratory (UL)

F. Underwriters Laboratory of Canada (ULC)

G. Uniform Building Code (UBC)

### 1.04 SYSTEM DESCRIPTION

A. Performance Requirements: Provide corner guard systems that conform to the following requirements of regulatory agencies and the quality control of IPC Door and Wall Protection Systems, InPro Corporation.

1. Fire Performance Characteristics: Provide UL Classified corner guards conforming with NFPA Class A fire rating. Surface burning characteristics, as determined by UL-723 (ASTM E-84), shall be flame spread of 10 and smoke development of 350 - 450. Provide ULC (Canada) listed corner guards conforming to the requirements of the National Building Code of Canada 2010, Subsection 3.1.13. Surface burning characteristics, as determined by CAN/ULC-S102.2, shall be flame spread of 15 and smoke developed of 35.

2. Self-extinguishing: Provide corner guards with a CC1 classification, as tested in accordance with the procedures specified in ASTM D-635-74, Standard Test Method for Rate of Burning and/or Extent and Time of Burning of Self-Supporting Plastics in a Horizontal Position, as referenced in UBC 52-4-1988.

3. Impact Strength: Provide rigid vinyl profile materials that have an Impact Strength of 30.2 ft-lbs/inch of thickness as tested in accordance with the procedures specified in ASTM D-256-90b, Impact Resistance of Plastics.

4. Chemical and Stain Resistance: Provide corner guards that show resistance to stain when tested in accordance with applicable provisions of ASTM D-543.

5. GREENGUARD Certified: Provide GREENGUARD Certified material. Profiles shall meet the requirements of GREENGUARD Certification Standards for Low-Emitting Products and GREENGUARD Product Emission Standard for Children & Schools.

6. Fungal and Bacterial Resistance: Provide rigid vinyl that does not support fungal or bacterial growth as tested in accordance with ASTM G-21 and ASTM G-22.

7. Colour Consistency: Provide components matched in accordance with SAE J-1545 - (Delta E) with a colour difference no greater than 1.0 units using CIE Lab, CIE CMC, CIE LCh, Hunter Lab or similar colour space scale systems.

### 1.05 SUBMITTALS

A. Product Data: Manufacturer's printed product data for each type of corner guard specified.

B. Detail Drawings: Mounting details with the appropriate adhesives for specific project substrates.

C. Samples: Verification samples of corner guard, 203mm long, in full size profiles of each type and colour indicated.

D. Manufacturer's Installation Instruction: Printed installation instructions for each corner guard.

### 1.06 DELIVERY, STORAGE AND HANDLING

A. Deliver materials in unopened factory packaging to the jobsite

B. Inspect materials at delivery to assure that specified products have been received.

C. Store in original packaging in a climate-controlled location away from direct sunlight.

### 1.07 PROJECT CONDITIONS

A. Environmental Requirements: Products must be installed in an interior climate-controlled environment.

### 1.08 WARRANTY

A. Standard IPC Limited Lifetime Warranty against material and manufacturing defects.

## PART 2 - PRODUCTS

### 2.01 SUPPLIER

A. Acculine Architectural Systems: 135-139 Northcorp Blvd, Broadmeadows VIC 3047, Telephone: (03) 9334 5911, [www.acculine.com.au](http://www.acculine.com.au)

### 2.02 MANUFACTURER

A. Acceptable Manufacturer: IPC Door and Wall Protection Systems, InPro Corporation, PO Box 406 Muskego, WI 53150 USA; Telephone: 800.222.5556, Fax: 888.715.8407, [www.inprocorp.com](http://www.inprocorp.com)

B. Substitutions: Not permitted

C. Provide all corner guards and wall protection from a single source.

### 2.03 MANUFACTURED UNITS

A. Corner Guard System

1. 160F Flush Mount Corner Guard Profile:  
51mm x 51mm 90 degree  
1.22m, 2.44, 2.74m and 3.66m standard heights.  
Custom heights and angles available

### 2.04 MATERIALS

A. Vinyl: Snap on cover of 2mm thickness shall be extruded from chemical and stain resistant polyvinyl chloride with the addition of impact modifiers. No plasticizers shall be added (plasticizers may aid in bacterial growth).

B. Aluminium: Continuous aluminium retainer of 1.8mm thickness shall be fabricated from 6063-T5 aluminium, with a mill finish.

### 2.05 COMPONENTS

A. Cove Base Retainer: Optional cove base retainer shall be fabricated from 6063-T5 aluminium with a mill finish.

B. Closure Cap: Optional closure cap shall be fabricated from .8mm thick aluminium

C. Fasteners: All mounting system accessories appropriate for substrates indicated on the drawings shall be provided.

### 2.06 FINISHES

A. Vinyl Cover: Colour of corner guard to be selected by the architect from the IPC finish selection. Surface shall have a pebblette texture.

## PART 3 - EXECUTION

### 3.01 EXAMINATION

A. Examine areas and conditions in which the corner guard systems will be installed.

B. Wall surface shall be dry and free from dirt, grease and loose paint.

### 3.02 PREPARATION

A. General: Prior to installation, clean substrate to remove dust, debris and loose particles.

### 3.03 INSTALLATION

A. General: Locate corner guard as indicated on approved detail drawings for the appropriate substrate, and in compliance with the IPC installation instructions. Install corner guard level and plumb.

B. Installation of 160F Flush Mount Corner Guard:

1. Drywall installation: Drywall must be installed 38mm back from the corner of the stud.

2. Position the aluminium retainer in the recess formed by the drywall. The mounting flange of the retainer rests over the edge of the drywall. If you are using the aluminium cove base retainer, snap it on the aluminium retainer before attaching the retainer to the studs.

3. Attach the aluminium retainer to the studs using 32mm bugle head drywall screws, 457mm on centre, through the pre-punched holes on the mounting flange.

4. Cover the mounting flange with joint compound. Feather and finish with the surface of the drywall. When installing flush mount corner guards at less than ceiling height, use the optional closure cap. Attach the closure cap to the top of the aluminium retainer with 32mm Phillips round head self-tapping screws through each mounting tab. Feather and finish the exposed edge of the closure cap with the surface of the drywall. Alternately, standard drywall trim may be used to finish the top edge. Appropriate use of trim will aid in the feathering of joint compound to the corner guard vinyl.

5. After the joint has been finished, position the vinyl cover over the aluminium retainer. Push the vinyl cover over the aluminium, pressing over the entire length until the vinyl snaps securely in place.

### 3.04 CLEANING

A. At completion of the installation, clean surfaces in accordance with the IPC clean-up and maintenance instructions.