

Installation Instructions

2000 Series Handrail

Important

1. Acclimate materials 24 hrs before installation. Maintain temperature-controlled environment after installation
2. Install in accordance with manufacturer's installation instructions. Failure to do so will void the warranty.

Installation tips

1. Cut covers up to 1.6mm longer to ensure a tight fit.
2. Lubricate blades when cutting aluminium to reduce burrs.

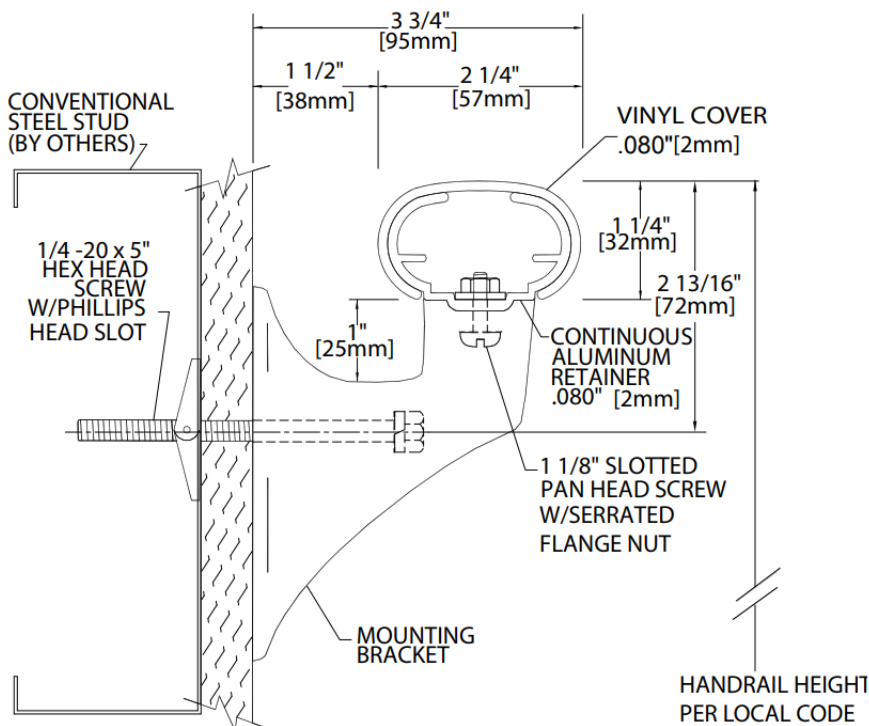
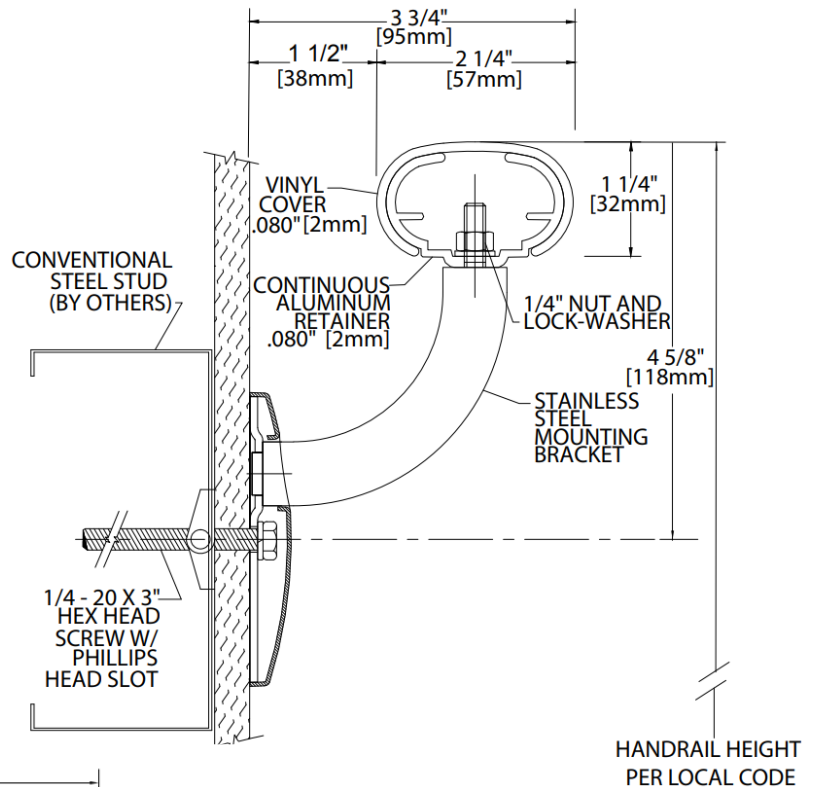

Recommended Tools

Safety Glasses, Tape Measure, 10mm socket for machine screw hex bolt, 11mm socket for wood screw hex bolt Level, Power Drill, Drill Bits – 6mm masonry (concrete/concrete block), Power Mitre Saw, 254mm Blade with 60-80 Carbide Tipped Teeth

Installation Instructions

2000 Series Handrail

Components and fasteners

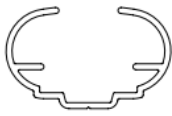

2000A
CONTINUOUS
ALUMINUM RETAINER

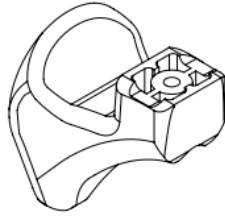

2001
MOUNTING BRACKET



2001SS
MOUNTING BRACKET



2000V
COVER

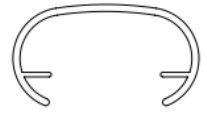

2000HR REVEAL
STANDARD ON
2000W, G2-2000

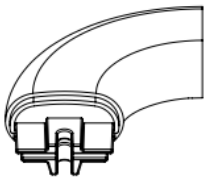

2002
LEFT RETURN

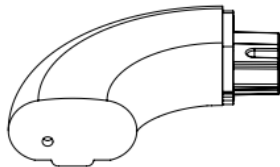

2003
RIGHT RETURN

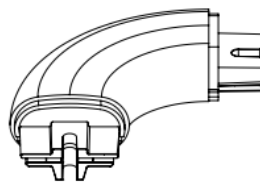

2004
INSIDE/OUTSIDE
CORNER

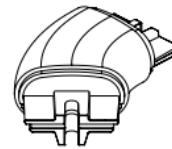

2004135
INSIDE/OUTSIDE
CORNER

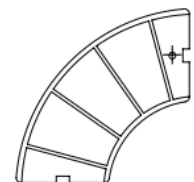

2005
BOTTOM OF RETURN

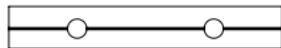

906
SPLICE



1/4"
LOCK WASHER
SPRING REGULAR



1/4-20
FLANGED SCREW
HEX NUT



1 1/8" SLOTTED
PAN HEAD BOLT

Wall Condition	Specified Fasteners
Steel Stud/Gypsum Wall	1/4-20 x 5" Phillips hex head Bolt with toggle wing and lock washer
Concrete/Concrete Block	1/4-20 x 5" Phillips hex head bolt with lead anchor and lock washer
Wood Stud/Gypsum Wall	1/4" x 5" Hex Head Wood Screw and lock washer
16 gauge steel Backer/Gypsum wall	#14 X 4" Indented hex washer, zink-plated TEK SCREW
Steel Stud or Metal Backer/Drywall (OSHPD)	1/4-20 x 5" Phillips hex head Bolt with lock washer and 1/4" Hilti Toggler
Concrete/Concrete Block (OSHPD)	1/4" x 4" Torx Hex Washer Head Screw (Hilti Kwik-Con II) and lock washer
Wood Stud or Wood Backer/Gypsum Wall (OSHPD)	1/4" x 5" Hex Head Wood Screw and lock washer
Wood Stud/Gypsum Wall	1/4" x 3" Hex head wood screw and lock washer
Steel Stud/Gypsum Wall	1/4-20 x 3" Phillips hex head Bolt with toggle wing and lock washer
Concrete/Concrete Block	1/4-20 x 3" Phillips hex head bolt with lead anchor and lock washer

Installation Instructions

2000 Series Handrail

Layout view

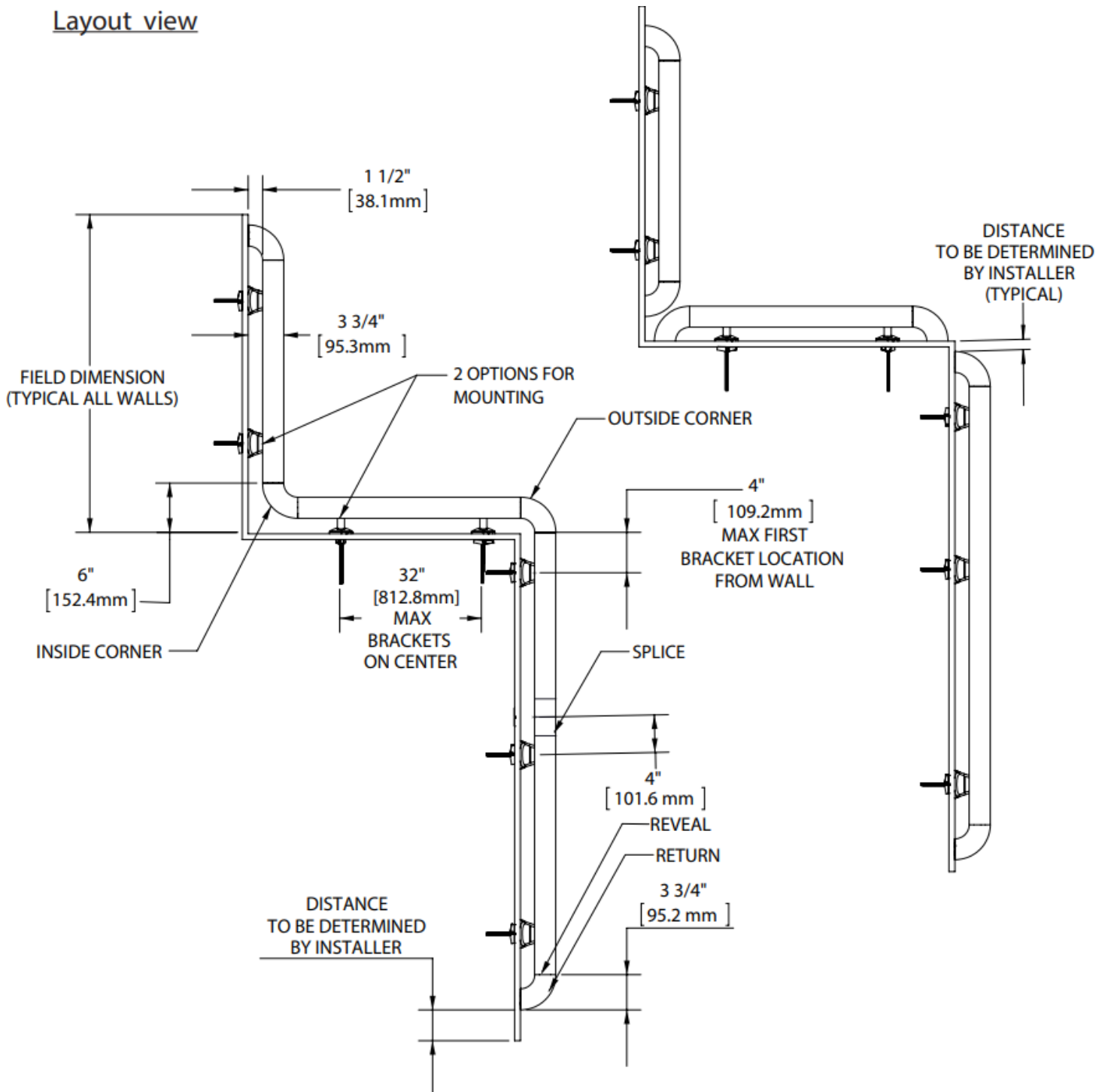

Installation Instructions

2000 Series Handrail

Exploded view assembly

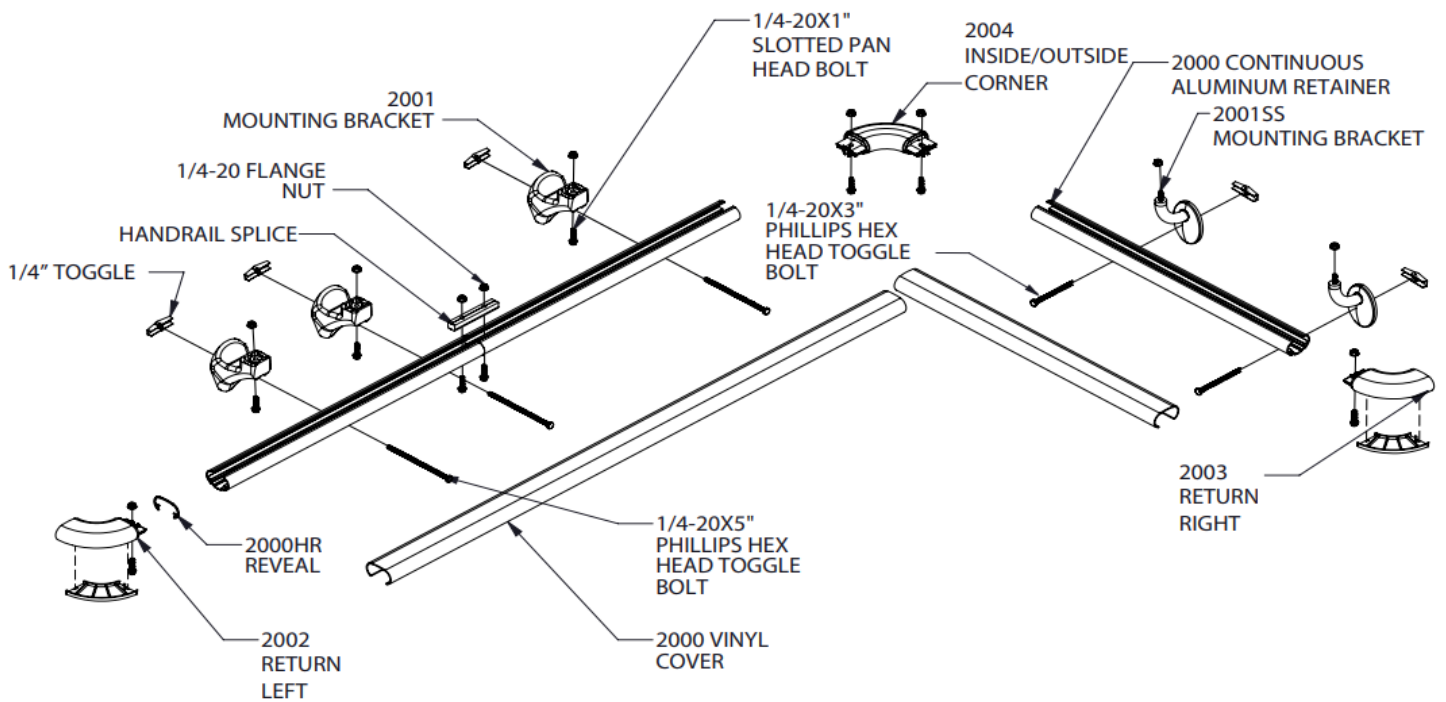

Installation Instructions

2000 Series Handrail

FIG. 1

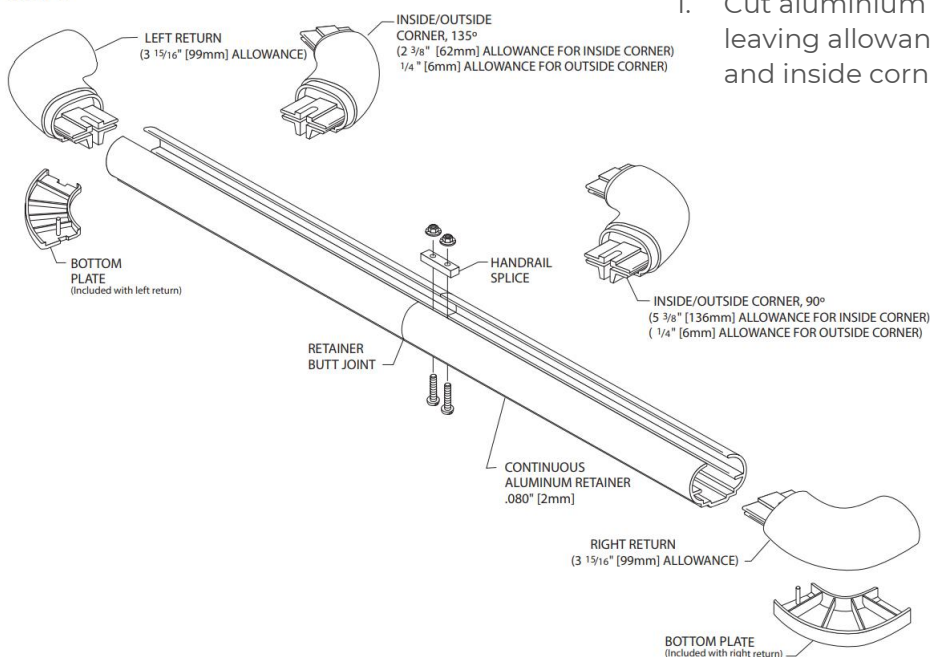

1. Cut aluminium retainer to desired length, leaving allowance for returns, outside corners and inside corners. See Figure 1.

FIG. 2

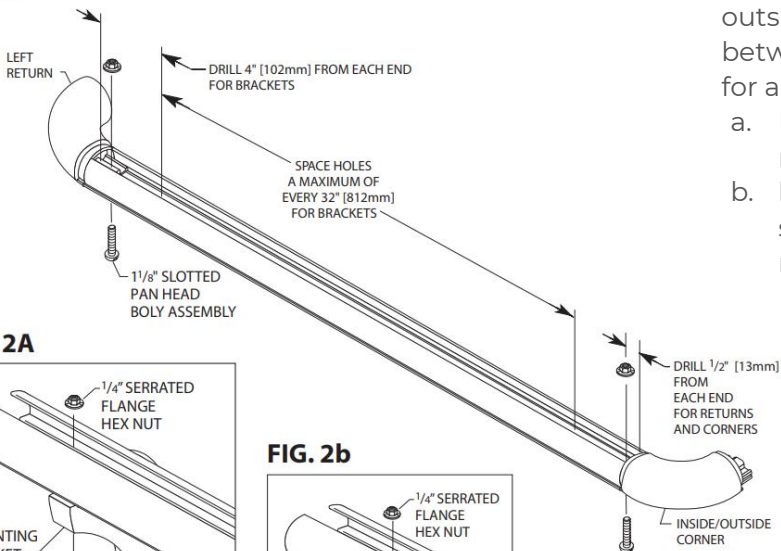

2. Drill holes in centreline of aluminium retainer for brackets, returns and corners using 6mm drill bit. Attach returns, inside corners and outside corners to retainer leaving a 1.5mm gap between returns/corners and retainer to allow for adjustment. See Figure 2.
 - a. Plastic Brackets - Attach brackets to retainer. See Figure 2a.
 - b. Stainless Steel Brackets - Slip stainless steel cover over post. Insert post through retainer hole and attach. See Figure 2b.

FIG. 2A

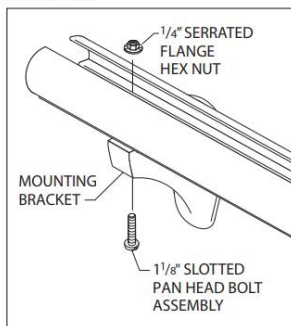
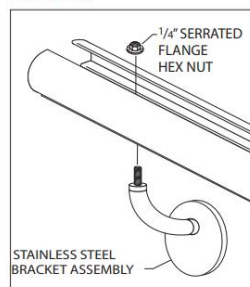

FIG. 2b



Installation Instructions

2000 Series Handrail

FIG. 3

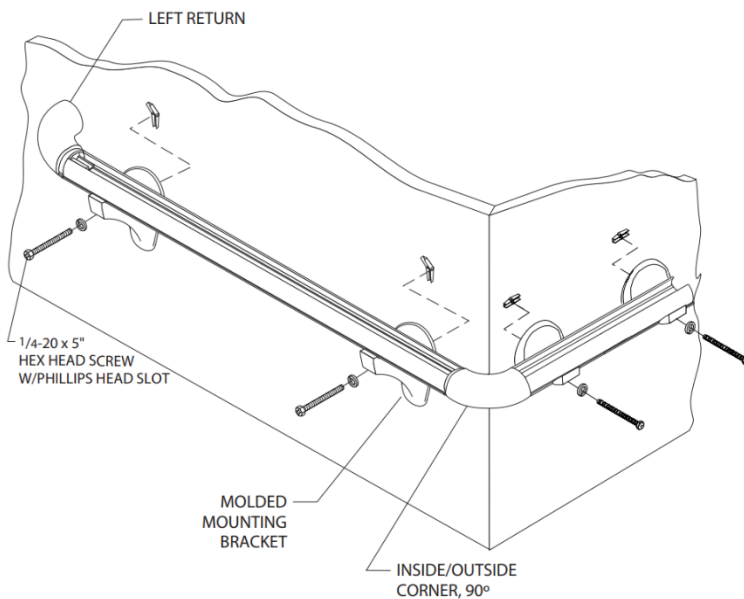

3. Position retainer against wall at desired height. Level and mark bracket holes on wall. Drill marked holes with 19mm drill bit for toggle bolts (drywall installation) or 13mm drill bit for lead anchor (concrete wall installation). Loosely attach mounting bolts to the brackets. Mount on wall, level retainer and tighten screws to secure. See Figure 3.

NOTE: For stainless steel bracket, snap cover over mounting base when retainer is secure. See Figure 3a.

FIG. 3a

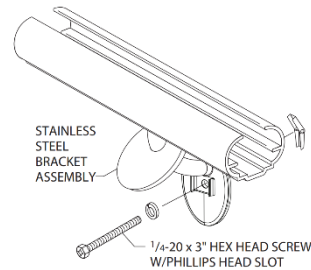
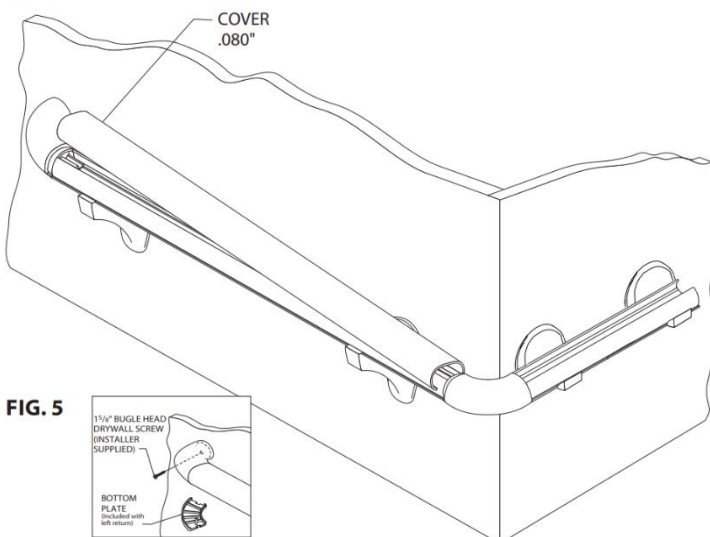

FIG. 4



4. Cut cover to length between returns and/or corners. (Note: Trim factory edges square before installation). Position cover on retainer and adjust returns and/or corners for a tight fit. Starting at one end and work to the other end by pushing the cover onto the retainer until it is securely in place. See Figure 4.

NOTE: Returns should be secured to the wall. Remove bottom plate and fasten installer supplied screws through hole located in the return. Reattach bottom plate. See Figure 5.