

110 Series New to Existing

A01 - Floor to Floor

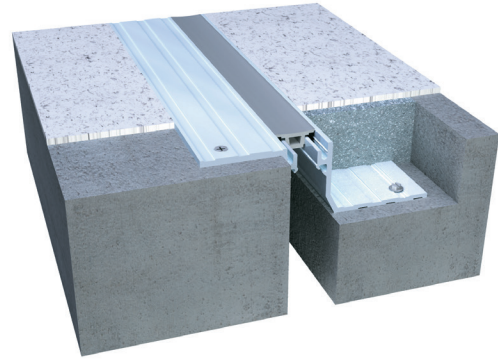

Movement Rating ± 25%

Product Guide



Thermal



Interior



Fire Rated Option



Vapor Barrier Option



ADA Compliant

- ▶ Dual durometer seal provides secure fit and optimal flexibility
- ▶ Seals absorb limited serviceable seismic movement
- ▶ Designed for retrofits, additions and renovations where blockout occurs on one side only
- ▶ Adaptable to many floor finishes including concrete, epoxy, ceramic tile, vinyl, carpet, marble and stone
- ▶ Seamlessly integrates with the following wall and ceiling systems
- ▶ Easy to clean flush seals No dirt or water traps
- ▶ Snap-fit design for easy on site assembly
- ▶ Mill finish aluminum
- ▶ Integral vapor barrier option available
- ▶ Standard seal colors: black, beige, gray, off white and bright white. Custom colors available upon request.

Application	System	W		H1		H2		S		B		Movement +/-			
		Joint Width		Frame Height 1		Height 2		Sightline		Blockout		Horizontal		Vertical	
		US	mm	US	mm	US	mm	US	mm	US	mm	US	mm	US	mm
Floor to Floor	110-A01-025	1"	25	1 1/2"	38	1/8"	4	2 1/2"	64	2 1/2"	64	1/4"	6	1/4"	6
	110-A01-038	1 1/2"	38	1 1/2"	38	1/8"	4	2 5/16"	75	2 1/2"	64	3/8"	10	3/8"	10
	110-A01-050	2"	51	1 1/2"	38	1/8"	4	3 3/8"	86	2 1/2"	64	1/2"	13	1/2"	13
	110-A01-075	3"	76	1 1/2"	38	1/8"	4	4 1/2"	113	2 1/2"	64	3/4"	19	3/4"	19

Standard frame height for recessed side 1 1/2" (38mm), 25mm and 50mm available

IPC.740/REV.5

110 Series

New to Existing Floor Systems

110-A01 Floor/Floor for VCT
(2" (50mm) system shown)

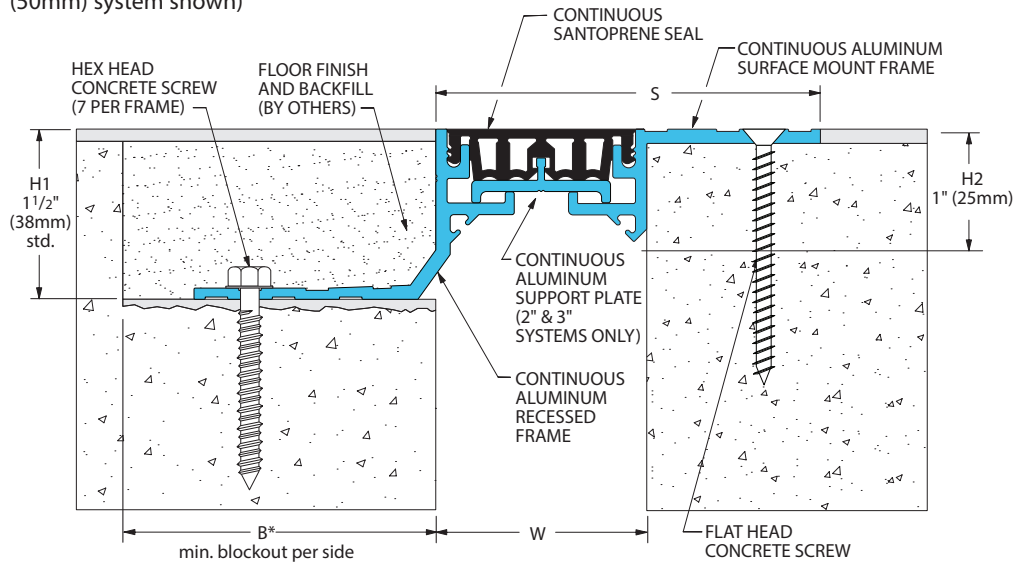

110 Series

Options

Fire Blanket System
(110-A01-050 system shown)

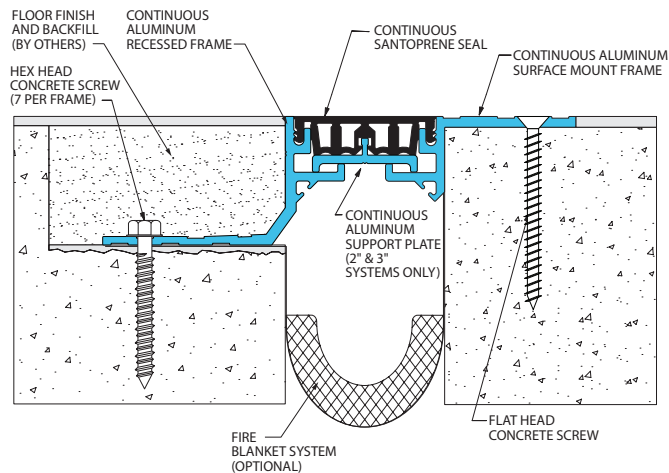

Vapor Barrier System
(110-A01-050 system shown)

